

SPLScar™ Block

(#201935/201938/201936/201937/201939/201930/201916/201904/201914/201934/201902/201903)

1. Description

SPLScar™ Block is easily attachable to surface, and thus applicable to a variety of products for studying cell migration, wound healing, and metastasis of cancer cell. Block is composed of 500 μm thick wall to artificially generate cell free gap(s), insuring higher uniformity and reproducibility.

2. Features

- ❖ Cell Culture Dish (Cat. No. 201935, 201938)
- ❖ Confocal Dish (Cat. No. 201936, 201939 - Glass/Cat.No. 201937, 201930 - FLux)
- ❖ Confocal Plate (Cat. No. 201916)
- ❖ Cell Culture Slide (Cat. No. 201904 - Glass/Cat. No. 201914 - DLux/ Cat. No. 201934 - FLux)
- ❖ Individual (Cat. No. 201902 - 2well/ Cat. No. 201903 - 3well)
- ❖ Packed individually

3. Functional Test

Non-cytotoxic	:	Passed
Non-pyrogenic	:	Passed
DNase / RNase - free	:	Passed
Human DNA - free	:	Passed

4. Product Range

Cat. No.	Product Type	Bottom Type	Size	Block well type	Surface Treatment	Sterile	Packaging
201935	Cell Culture Dish	PS	35Ø	2	+	+	1/dish, total 30
201938	Cell Culture Dish	PS	35Ø	3	+	+	1/dish, total 30
201936	Confocal Dish	Glass	35Ø	2	+	+	1/dish, total 30
201937	Confocal Dish	FLux	35Ø	2	+	+	1/dish, total 30
201939	Confocal Dish	Glass	35Ø	3	+	+	1/dish, total 30
201930	Confocal Dish	FLux	35Ø	3	+	+	1/dish, total 30
201916	Confocal Plate	Glass	6 well	2	-	+	6/plate, total 18
201904	Cell culture slide	Glass	4 well	3	-	+	4/slide, total 24
201914	Cell culture slide	DLux	4 well	3	+	+	4/slide, total 24
201934	Cell culture slide	FLux	4 well	3	+	+	4/slide, total 24
201902	Individual	-	-	2	-	+	total 25
201903	Individual	-	-	3	-	+	total 25

5. Certification

SPL Life Sciences hereby certifies that the product identified above, inspected to be in compliance with product quality specification and requirements as documented in our ISO 9001:2015 Quality Management System (K-QA-Q031478) in Korea.

6. Product Photographs

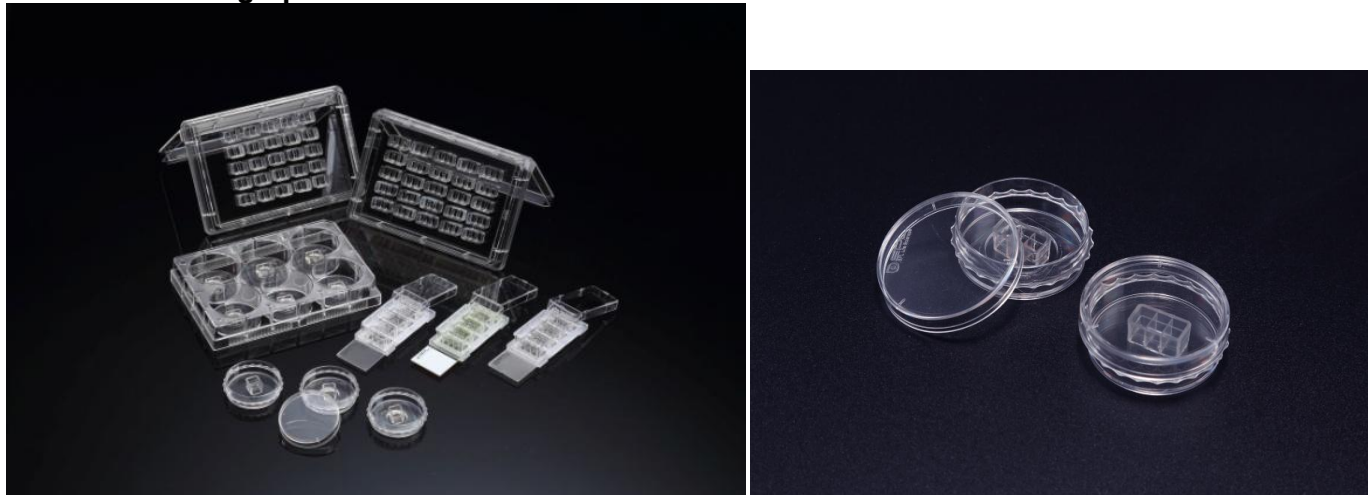

7. Specifications & Technical Drawing

(1) SPLScar™ Block- 2well (#201935/201936/201937/201916/201902)

- Specifications

Dimensions	Material (Resin)	Packaging		
<ul style="list-style-type: none">length: 8.63±1.00 mmWidth: 11.13±2.00 mmHigh: 6.0±2.00 mmWidth of Cell free gap: 0.5±0.05 mm	<ul style="list-style-type: none">Silicon	201935/201936/201937	201916	201902
		<ul style="list-style-type: none">Pieces/Sleeve: 3Pieces/Case: 30	<ul style="list-style-type: none">Pieces/Sleeve: 6Pieces/Case: 18	<ul style="list-style-type: none">Pieces/Sleeve: 25Pieces/Case: 25

- Technical Drawing

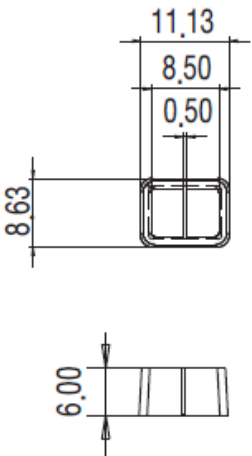

(2) SPLScar™ Scratcher- 3well (#201938/201939/201930/201904/201914/201934/201903)
 - Specifications Dimensions

- Specifications

Dimensions	Material (Resin)	Packaging		
<ul style="list-style-type: none"> length: 8.63±1.00 mm Width: 15.63±2.00 mm High: 6.0±2.00 mm Width of Cell free gap: 0.5±0.05 mm 	<ul style="list-style-type: none"> Silicon 	201938/201939/201930	201904/201914/201934	201903
		<ul style="list-style-type: none"> Pieces/Sleeve: 3 Pieces/Case: 30 	<ul style="list-style-type: none"> Pieces/Sleeve: 4 Pieces/Case: 24 	<ul style="list-style-type: none"> Pieces/Sleeve: 25 Pieces/Case: 25

- Technical Drawing

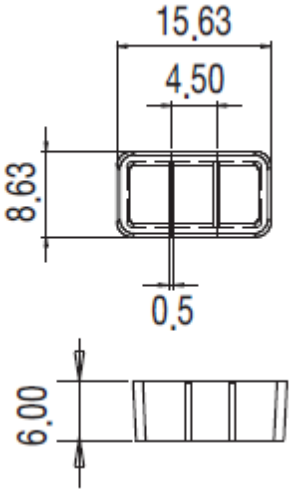

www.spllifesciences.com

For technical assistance, contact SPL R&D Center at:
 Tel: +82-31-533-4800; Fax: +82-31-533-1430; e-mail: spl@ispl.co.kr
 To place an order, contact your local distributor or
 Tel: +82-31-533-4800; Fax: +82-31-533-1430; e-mail: business@ispl.co.kr

SPL-TDS-SSB

For Research Use Only. Not intended for use in diagnostic or therapeutic procedures.
 © SPL Life Sciences Co., Ltd., Version 4, MAR. 8th, 2022

